

3RD FLOOR -
ANTE NATAL CARE

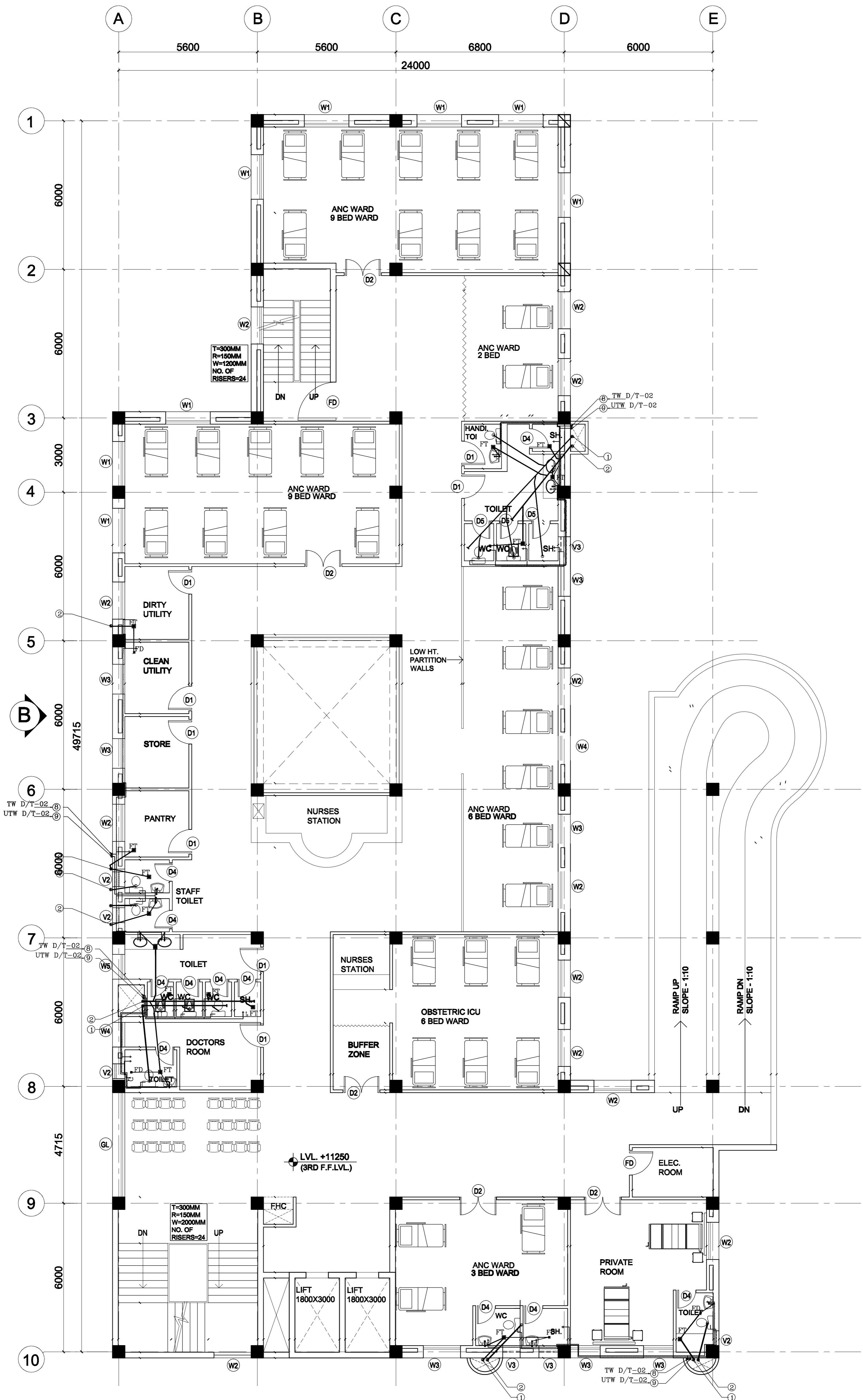

This drawing with all its contents is the sole intellectual property of the Hospital Services Consultancy Corporation (HSCC) and shall not be used for any other drawing or part thereof for its use in any form whatsoever without the written permission of HSCC is prohibited.

NORTH

LEGEND:

1	100 Ø CI SOIL & VENT PIPE
2	100Ø CLWASTE & VENT PIPE
3	100Ø CI SOIL PIPE
4	100Ø CI WASTE PIPE
5	50Ø uPVC SOIL PIPE
6	40Ø uPVC WASTE PIPE
7	32Ø uPVC WASTE PIPE
8	TW DN / TAKE
9	UTW DN / TAKE
10	150 Ø S.W. PIPE
F.1	FLOOR TRAP 100X100
F.D	FLOOR DRAIN 50Ø
FCO	FLOOR CLEAN OUT VALVE
MH	MANHOLE (900X800)mm
GI	GULLY TRAP (300X300)mm

PROJECT

PROPOSED
100 BEDED
HOSPITAL
MUJAFARNAGAR
(UP)

TITLE PLUMBING
TENDER DRAWING

THIRD FLOOR PLAN

HSCC/D&E/M/HS/3D/PL-04
Drawing No.

Job No.	Scale	Date
App by	Rev. by	Prep. by

HSCC (INDIA) LIMITED
(A GOVERNMENT OF INDIA ENTERPRISE)
HSCC
NEW DELHI INDIA