

**CHHATTISGARH MEDICAL SERVICES CORPORATION
LIMITED**

(Government of Chhattisgarh)

Tender

For

**Construction of Regional Drug Warehouse at Kanker (C.G.), under
National Rural Health Mission scheme**

Tender Drawings

VOLUME-VI

June' 2013



**HSCC (INDIA) LTD.
(CONSULTANTS & ENGINEERS FOR MEGA HOSPITALS & LABORATORIES)
E-6(A), sector-1, NOIDA(U.P) 201301 (India)**

Phone : 0120-2542436-40

Fax : 0120-2542447

Tender No. HSCC/NRHM/CG./2013 (II) /23

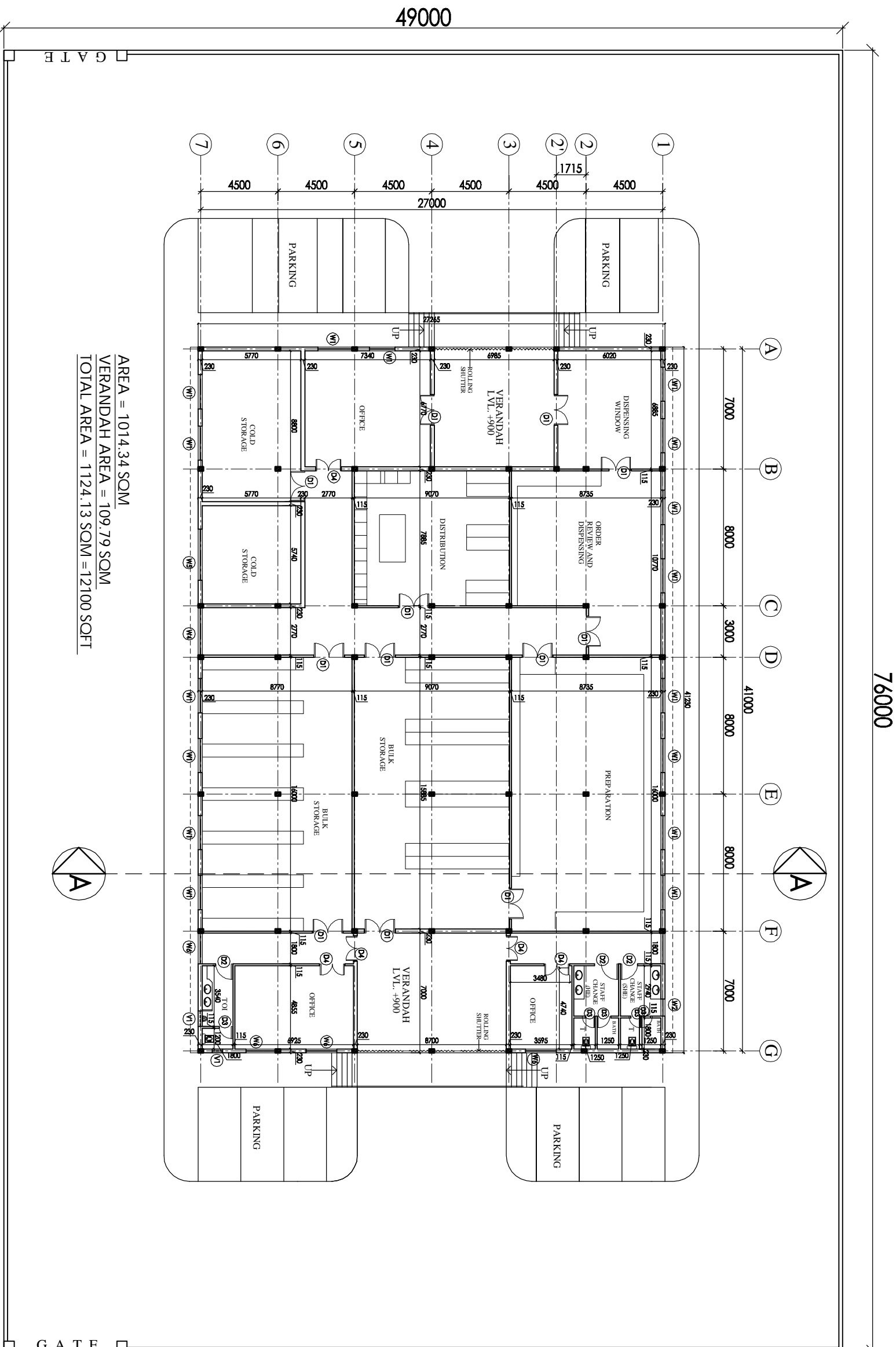

AREA = 1014.34 SQM
 VERANDAH AREA = 109.79 SQM
 TOTAL AREA = 1124.13 SQM = 12100 SQFT

76000

49000

GATE

GATE

THE DRAWING SHALL BE THE PROPERTY OF HSCC AND NOT BE LOANED, REPRODUCED, COPIED, EITHER WHOLLY OR IN PART, OR BY ANY MEANS, WITHOUT THE WRITTEN PERMISSION OF HSCC. IN CASE OF BREACH OF THIS CONDITION, HSCC SHALL BE ENTITLED TO TAKE LEGAL ACTION. DRAWINGS TO BE READ NOT REVERSED

NOTES

SER. NO.	DESCRIPTION	PLAN	CAL. LVL.	UNIT	L.V.L.
1	G1	5905	±00	-2400	
2	W1	2000	+1000	+2400	
3	W2	1000	+1000	+2400	
4	W3	2700	+1000	+2400	
5	W4	2770	+1000	+2400	
6	W5	3000	+1000	+2400	
7	W6	1800	+1000	+2400	
8	D1	1800	-	+2100	
9	D2	1000	-	+2100	
10	D3	750	-	+2100	
11	D4	1500	-	+2100	
12	V1	900	+2100	+2400	

PROJECT
 PROPOSED
 DRUG WAREHOUSE

AREA - 12100 SQFT

TITLE
 TENDER DRAWING
 (ARCHITECTURE)
 FLOOR PLAN

HSCC/ID/CH. WAREHOUSE/01		R-1	
Drawing No.	1-230	Revision	
Job No.	Scale	Date	26-06-2013
App. By:	Rev. By:	Prep. By:	

THIS DRAWING SHALL BE
 CONSIDERED AS THE WORK OF THE
 HOSPITAL SERVICES
 CONSULTING CORPORATION
 (A) GOVERNMENT OF INDIA
 WITHOUT THE WRITTEN PERMISSION
 OF HSCC IS PROHIBITED.
 DRAWINGS TO BE READ
 NOT REVERSED

NOTES

Sl. No.	Location/Point	Height	Level	Vertical Elev.
1	G1	595	±0	+240
2	W1	300	+100	+240
3	W2	1000	+1000	+240
4	W3	2700	+1000	+240
5	W4	2770	+1800	+240
6	W5	3000	+1000	+240
7	W6	1800	+1000	+240
8	D1	1800	-	+2100
9	D2	1000	-	+2100
10	D3	750	-	+2100
11	D4	1350	-	+2100
12	V1	900	+2100	+240

PROJECT
PROPOSED
DRUG WAREHOUSE

TITLE
TENDER DRAWING
(ARCHITECTURE)

TERRACE PLAN
SECTION

HSCC/ID/CH. WAREHOUSE/02	R-1	Revision
Drawn: No.		
Job No.	1-250	Scale
Date	26-06-2013	
Appr. By.	Rev. By.	Prep. By.

HSCC
 HSCC (INDIA) LIMITED
 (A GOVERNMENT OF INDIA ENTERPRISE)
 NEW DELHI INDIA

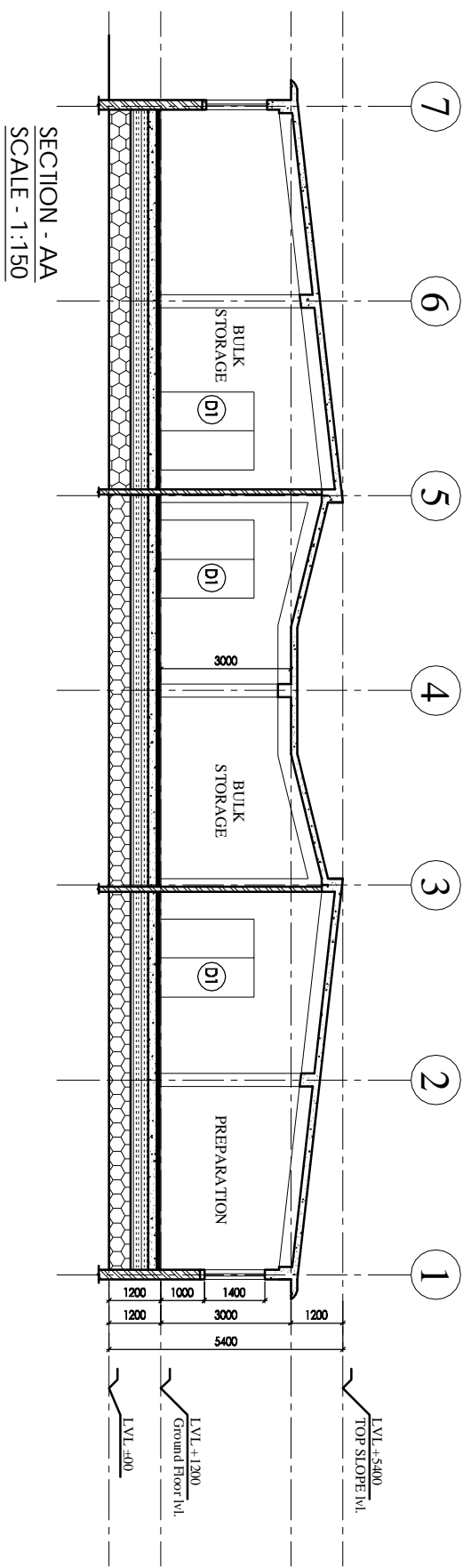
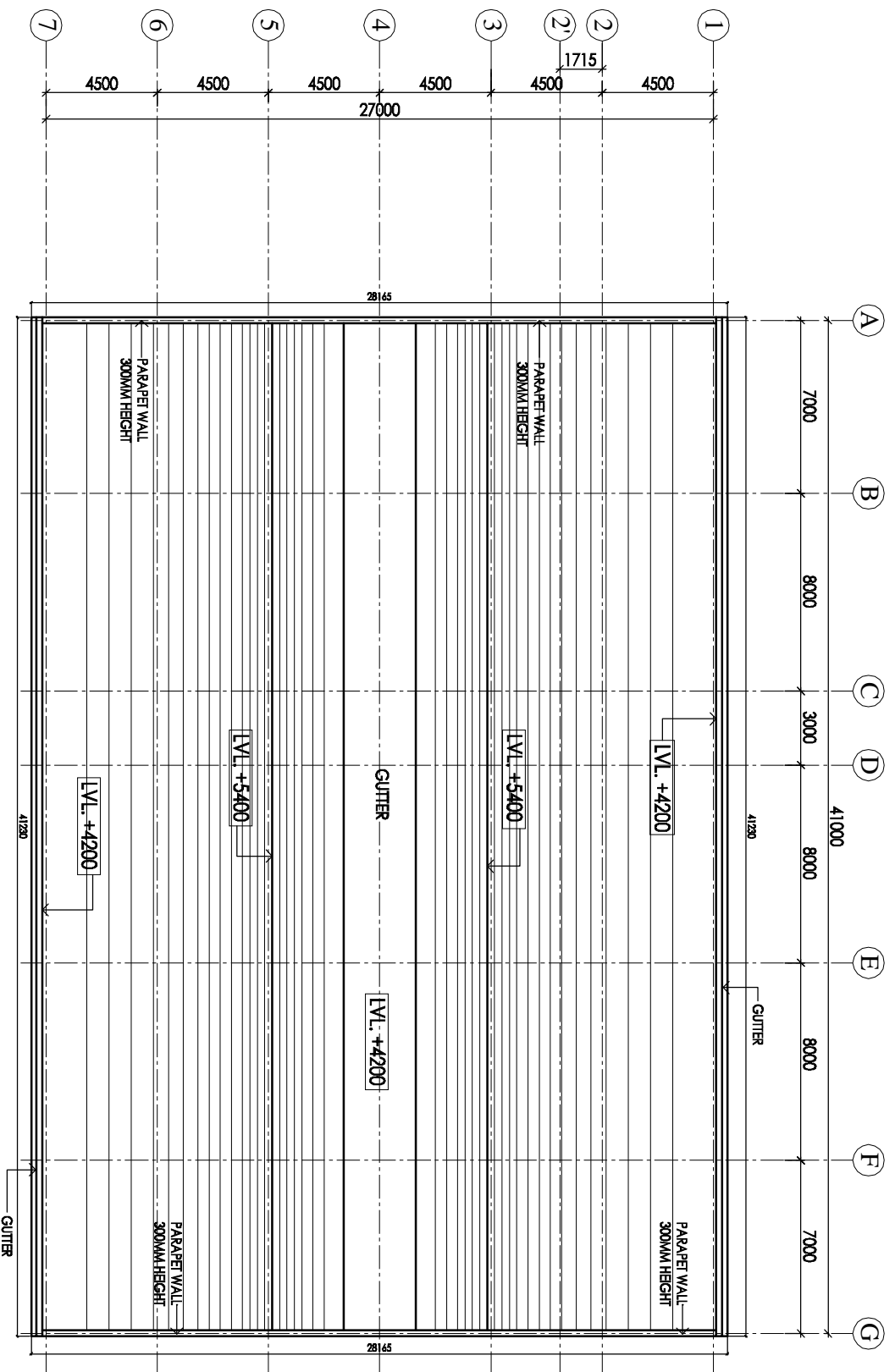

SECTION - AA
SCALE - 1:150

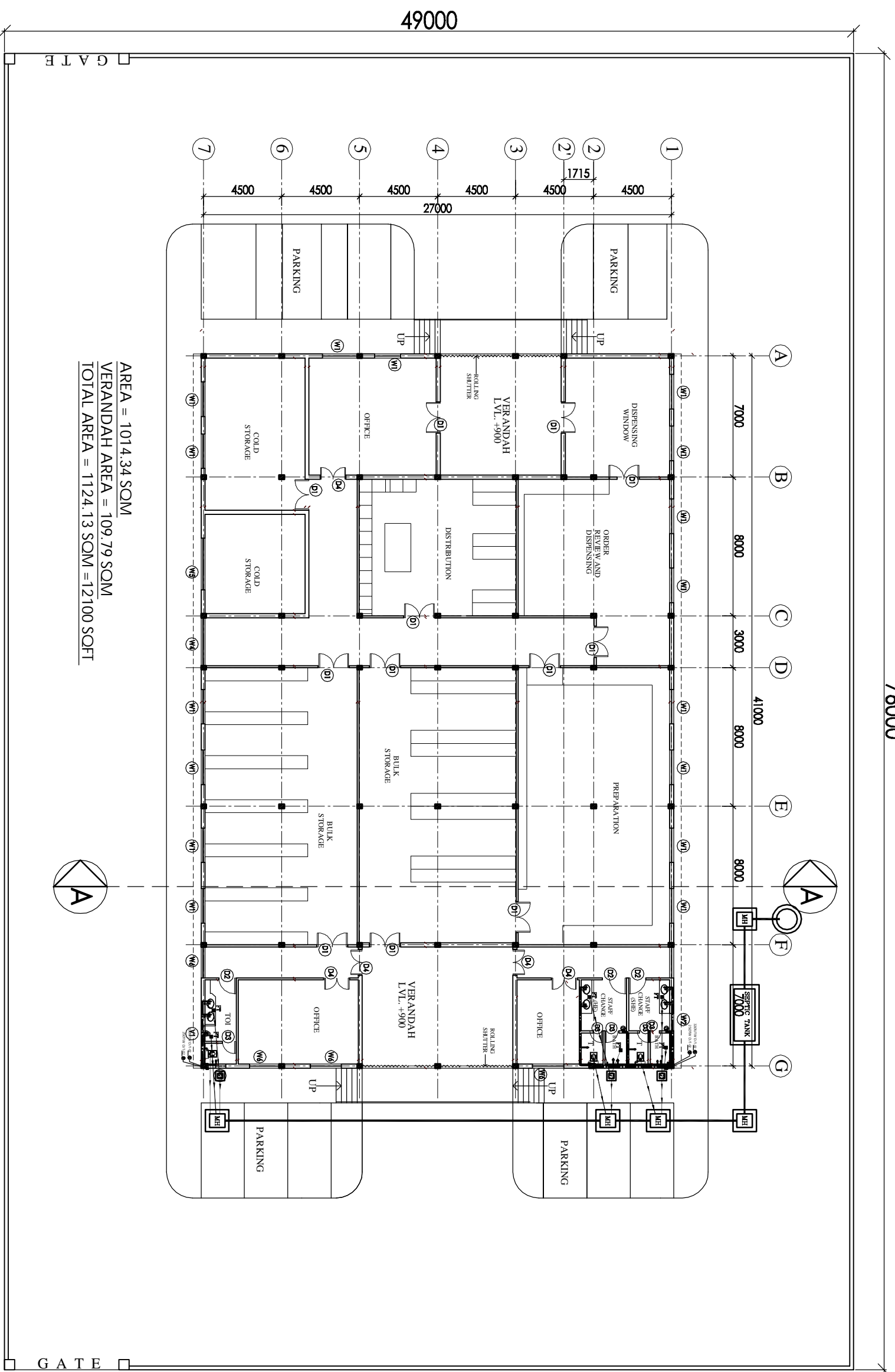

AREA = 1014.34 SOM
 VERANDAH AREA = 109.79 SOM
 TOTAL AREA = 1124.13 SOM = 12100 SQFT

LEGEND:

1	100 Ø CI SOIL & VENT PIPE
2	100Ø CI WASTE & VENT PIPE
3	100Ø CI SOIL PIPE
4	100Ø CI WASTE PIPE
5	80Ø UPVC SOIL PIPE
6	40Ø UPVC WASTE PIPE
7	32Ø UPVC WASTE PIPE
8	Ø UTW D/TAKE
9	Ø TW D/TAKE
10	100 Ø S.W. PIPE
FT	FLOOR TRAP 100x100
FD	FLOOR DRAIN 300
FCP	FLOOR CLEAN OUT
COP	CLEAN OUT PLUG
X	VALVE
MH	MANHOLE (600x400)mm
GT	GULLY TRAP (300x300)mm

76000

NOTES

1. GI
2. W1
3. W2
4. W3
5. W4
6. W5
7. W6
8. D1
9. D2
10. D3
11. D4
12. V1

SL. NO.	LOADING UNITS	THRU	VALVE	LEVEL
1	GI	500	+	+2400
2	W1	200	+	+2400
3	W2	100	+	+2400
4	W3	200	+	+2400
5	W4	270	+	+2400
6	W5	300	+	+2400
7	W6	180	+	+2400
8	D1	180	-	+2100
9	D2	100	-	+2100
10	D3	75	-	+2100
11	D4	150	-	+2100
12	V1	90	+	+2100

PROJECT
 PROPOSED DRUG WAREHOUSE
 CHATTISGARH

AREA - 12100 SQFT

TITLE- PLUMBING

TENDER DRAWING

FLOOR PLAN

HSCC/DAE/CH - WH/MD/R-01	R-1
Drawing No.	Revision
Job No.	Scale
	Date: JUNE 2013
App. By.	Rev. By.
	Prep. By.

HSCC
 HSCC (INDIA) LIMITED
 (A GOVERNMENT OF INDIA ENTERPRISE)
 NEW DELHI INDIA

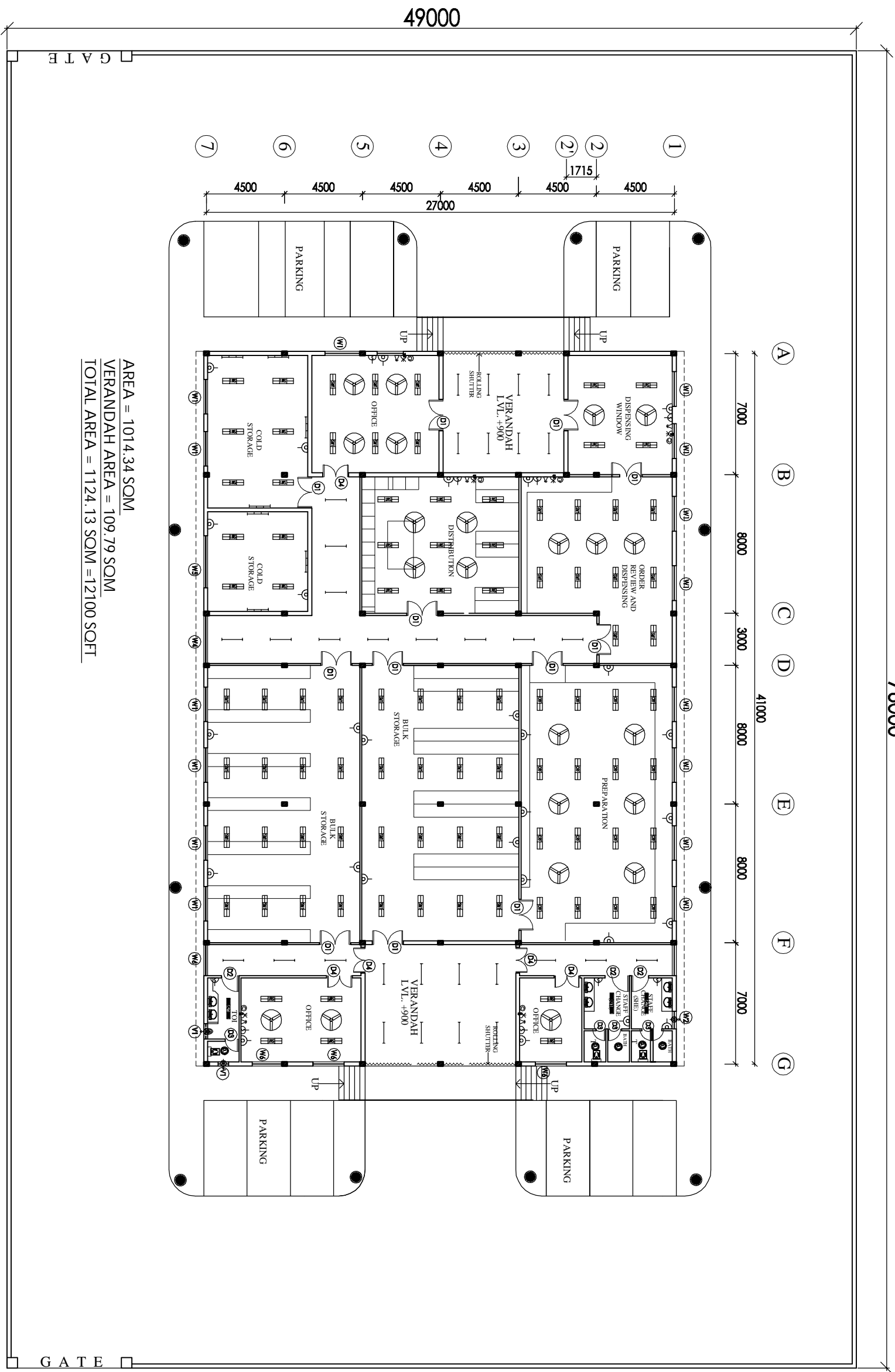

AREA = 1014.34 SOM
 VERANDAH AREA = 109.79 SOM
 TOTAL AREA = 1124.13 SOM = 12100 SQFT

NOTES

The drawing shall be used only for the purpose of the tender and shall not be used for any other purpose without the written permission of HSCC. The drawings shall be returned to HSCC immediately after the tender is opened. DRAWINGS TO BE READ NOT REVERSED

PROJECT
**PROPOSED
 DRUG WAREHOUSE**

AREA - 12100 SQFT

TITLE
TENDER DRAWING

FLOOR PLAN

ELECTRICAL LAYOUT

HSCC/CH. WAREHOUSE/E-01	R-1	Revision
Drawing No.	NTS	Scale
Job No.	Date:	
App. By:	Rev. By:	Prep. By: