

# ANNEXURE-1

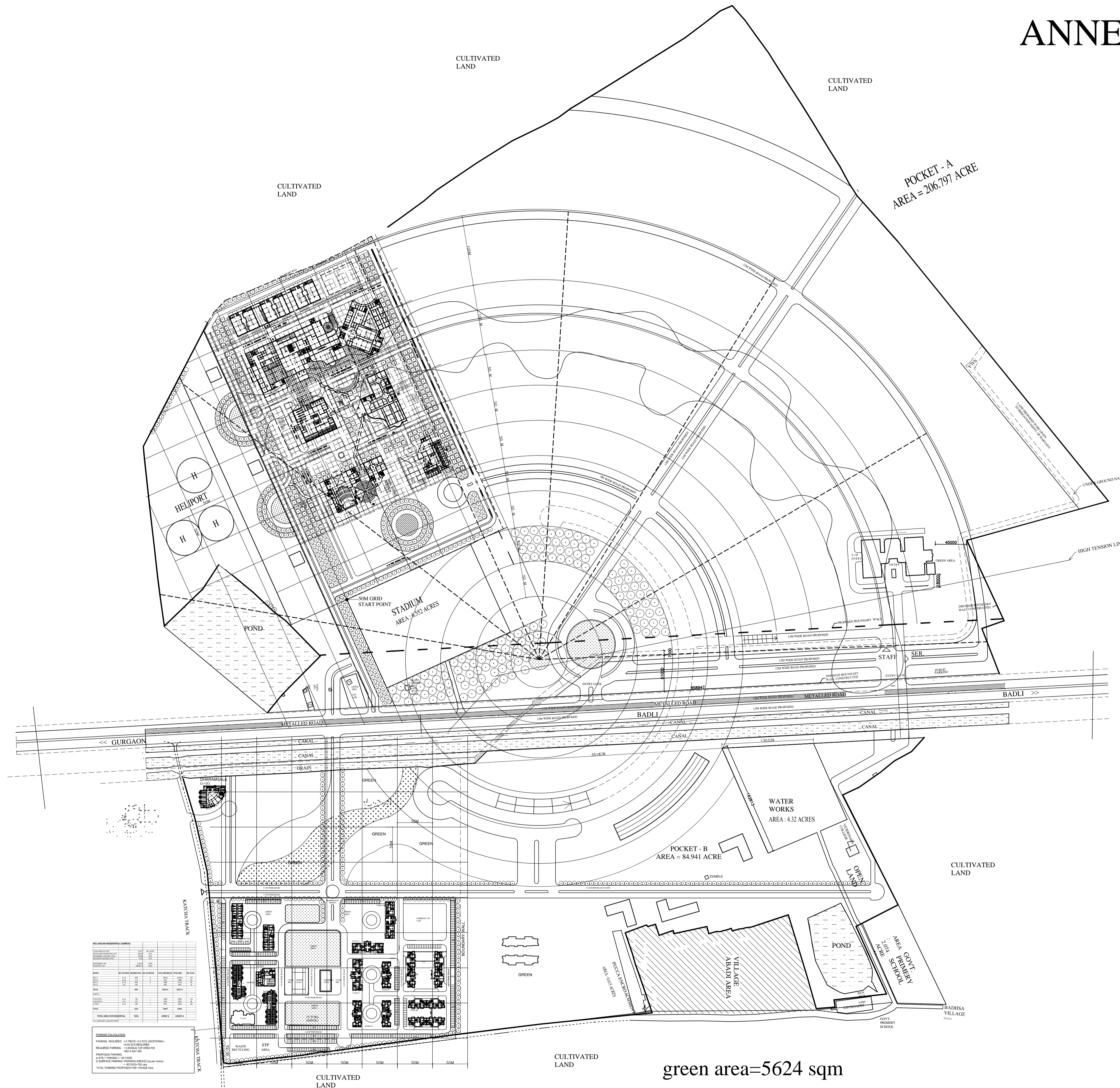

This drawing with all its contents is the sole intellectual property of the Hospital Services Consultancy Corporation (India) Ltd. Copying of this drawing or part thereof or its use in any form whatsoever without the written permission of HSCC is prohibited.

## NOTES

| REV      | DATE | DESCRIPTION |
|----------|------|-------------|
| REVISION |      |             |

**PROJECT**  
**ALL INDIA INSTITUTE OF MEDICAL SCIENCES (AIIMS)**  
**AT VILL. BARHSA JHAJJAR HARYANA**

**TITLE**  
**NATIONAL CANCER INSTITUTE**  
**HOSPITAL & HOUSING SITE LAYOUT PLAN**

HSCC/BUHP2/PG2/TD/HSP/002/R0  
 Drawing No. Rev.

|         |                |                     |
|---------|----------------|---------------------|
| Job No. | 1:150<br>Scale | 08-01-2013<br>Date: |
|---------|----------------|---------------------|

|        |         |                          |
|--------|---------|--------------------------|
| App by | Rev. by | NAVEEN KUMAR<br>Prep. by |
|--------|---------|--------------------------|

HSCC (INDIA) LIMITED  
 (A GOVERNMENT OF INDIA ENTERPRISES)  
**HSCC**  
 NEW DELHI INDIA

| Sl. No. | Particulars        | Area (Acres) | Area (Sq. Meters) |
|---------|--------------------|--------------|-------------------|
| 1       | STADIUM AREA       | 8552         | 34400000          |
| 2       | WATER WORKS AREA   | 432          | 1740000           |
| 3       | POCKET - A         | 206.797      | 8400000           |
| 4       | POCKET - B         | 84.941       | 3430000           |
| 5       | VILLAGE ABADI AREA |              |                   |
| 6       | GREEN AREA         |              | 5624              |
| 7       | ROADS              |              |                   |
| 8       | CANALS             |              |                   |
| 9       | DRAINS             |              |                   |
| 10      | OTHER AREAS        |              |                   |
| 11      | <b>TOTAL</b>       |              |                   |